

# TITAN

## Cordless Pole Hedge Trimmer/ Pruner

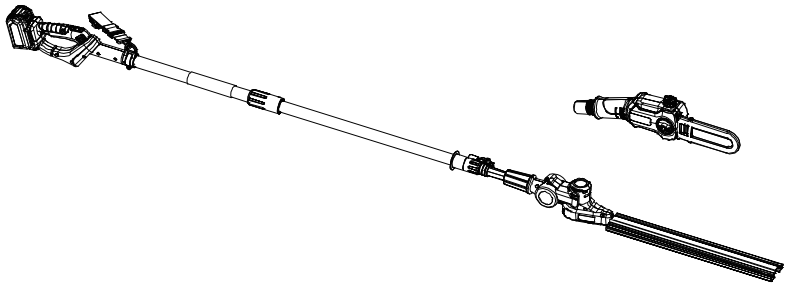

Original Instructions\_MNL\_TTT831HDC\_V1\_211108

### TTT831HDC



WARNING: Read the instructions before using the product!

# Let's get started...

These instructions are for your safety. Please read through them thoroughly before use and retain them for future reference.



## Getting **started...** **02**

<b>Safety</b> information	03
<b>Your</b> product	19
<b>Before</b> you start	20



## **In more detail...** **30**

<b>Product</b> functions	31
<b>Operation</b>	35
<b>Care</b> and <b>maintenance</b>	42
<b>Troubleshooting</b>	48
<b>Recycling</b> and <b>disposal</b>	49
<b>Guarantee</b>	50
<b>Technical</b> specifications	52
<b>Declaration</b> of <b>conformity</b>	55

## Safety warnings

### General power tool safety warnings



**WARNING!** Read all safety warnings, instructions, illustrations and specifications provided with this power tool. *Failure to follow all instructions listed below may result in electric shock, fire and/or serious injury.*

**Save all warnings and instructions for future reference.**

*The term “power tool” in the warnings refers to your mains-operated (corded) power tool or battery-operated (cordless) power tool.*

### Work area safety

1. **Keep work area clean and well lit.** *Cluttered or dark areas invite accidents.*
2. **Do not operate power tools in explosive atmospheres, such as in the presence of flammable liquids, gases or dust.** *Power tools create sparks which may ignite the dust or fumes.*
3. **Keep children and bystanders away while operating a power tool.** *Distractions can cause you to lose control.*

### Electrical safety

1. **Power tool plugs must match the outlet. Never modify the plug in any way. Do not use any adapter plugs with earthed (grounded) power tools.** *Unmodified plugs and matching outlets will reduce risk of electric shock.*
2. **Avoid body contact with earthed or grounded surfaces, such as pipes, radiators, ranges and refrigerators.** *There is an increased risk of electric shock if your body is earthed or grounded.*

## Safety warnings

---

- 3. Do not expose power tools to rain or wet conditions.** *Water entering a power tool will increase the risk of electric shock.*
- 4. Do not abuse the cord. Never use the cord for carrying, pulling or unplugging the power tool. Keep cord away from heat, oil, sharp edges or moving parts.** *Damaged or entangled cords increase the risk of electric shock.*
- 5. When operating a power tool outdoors, use an extension cord suitable for outdoor use.** *Use of a cord suitable for outdoor use reduces the risk of electric shock.*
- 6. If operating a power tool in a damp location is unavoidable, use a residual current device (RCD) protected supply.** *Use of an RCD reduces the risk of electric shock.*

### Personal safety

- 1. Stay alert, watch what you are doing and use common sense when operating a power tool. Do not use a power tool while you are tired or under the influence of drugs, alcohol or medication.** *A moment of inattention while operating power tools may result in serious personal injury.*
- 2. Use personal protective equipment. Always wear eye protection.** *Protective equipment such as dust mask, non-skid safety shoes, hard hat, or hearing protection used for appropriate conditions will reduce personal injuries.*
- 3. Prevent unintentional starting. Ensure the switch is in the off-position before connecting to power source, picking up or carrying the tool.** *Carrying power tools with your finger on the switch or energising*

- power tools that have the switch on invites accidents.*
- 4. Remove any adjusting key or wrench before turning the power tool on.** *A wrench or a key left attached to a rotating part of the power tool may result in personal injury.*
  - 5. Do not overreach. Keep proper footing and balance at all times.** *This enables better control of the power tool in unexpected situations.*
  - 6. Dress properly. Do not wear loose clothing or jewellery. Keep your hair and clothing away from moving parts.** *Loose clothes, jewellery or long hair can be caught in moving parts.*
  - 7. If devices are provided for the connection of dust extraction and collection facilities, ensure these are connected and properly used.** *Use of dust collection can reduce dust-related hazards.*
  - 8. Do not let familiarity gained from frequent use of tools allow you to become complacent and ignore tool safety principles.** *A careless action can cause severe injury within a fraction of a second.*

### **Power tool use and care**

- 1. Do not force the power tool. Use the correct power tool for your application.** *The correct power tool will do the job better and safer at the rate for which it was designed.*
- 2. Do not use the power tool if the switch does not turn it on and off.** *Any power tool that cannot be controlled with the switch is dangerous and must be repaired.*
- 3. Disconnect the plug from the power source and/ or remove the battery pack, if detachable, from the power tool before making any adjustments, changing accessories, or storing power tools.** *Such preventive safety measures reduce the risk of starting the power tool accidentally.*

## Safety warnings

---

- 4. Store idle power tools out of the reach of children and do not allow persons unfamiliar with the power tool or these instructions to operate the power tool.** *Power tools are dangerous in the hands of untrained users.*
- 5. Maintain power tools.** Check for misalignment or binding of moving parts, breakage of parts and any other condition that may affect the power tool's operation. If damaged, have the power tool repaired before use. *Many accidents are caused by poorly maintained power tools.*
- 6. Keep cutting tools sharp and clean.** *Properly maintained cutting tools with sharp cutting edges are less likely to bind and are easier to control.*
- 7. Use the power tool, accessories and tool bits etc. in accordance with these instructions, taking into account the working conditions and the work to be performed.** *Use of the power tool for operations different from those intended could result in a hazardous situation.*
- 8. Keep handles and grasping surfaces dry, clean and free from oil and grease.** *Slippery handles and grasping surfaces do not allow for safe handling and control of the tool in unexpected situations.*

### Battery tool use and care

- 1. Recharge only with the charger specified by the manufacturer.** *A charger that is suitable for one type of battery pack may create a risk of fire when used with another battery pack.*
- 2. Use power tools only with specifically designated battery packs.** *Use of any other battery packs may create a risk of injury and fire.*

3. **When battery pack is not in use, keep it away from other metal objects, like paper clips, coins, keys, nails, screws or other small metal objects that can make a connection from one terminal to another.** *Shorting the battery terminals together may cause burns or a fire.*
4. **Under abusive conditions, liquid may be ejected from the battery; avoid contact. If contact accidentally occurs, flush with water. If liquid contacts eyes, additionally seek medical help.** *Liquid ejected from the battery may cause irritation or burns.*
5. **Do not use battery pack or tool that is damaged or modified.** *Damaged or modified batteries may exhibit unpredictable behaviour resulting in fire, explosion or risk of injury.*
6. **Do not expose a battery pack or tool to fire or excessive temperature.** *Exposure to fire or temperature above 130 °C may cause explosion.*
7. **Follow all charging instructions and do not charge the battery pack or tool outside the temperature range specified in the instructions.** *Charging improperly or at temperatures outside the specified range may damage the battery and increase the risk of fire.*

## Service

1. **Have your power tools serviced by a qualified repair person using only identical replacement parts.** *This will ensure that safety of the power tool is maintained.*
2. **Never service damaged battery packs.** *Service of battery packs should only be performed by the manufacturer or authorized service providers.*

## Safety warnings

---

### Hedge trimmer safety warnings:

1. **Keep all parts of the body away from the blade. Do not remove cut material or hold material to be cut when blades are moving.** *Blades continue to move after the switch is turned off. A moment of inattention while operating the hedge trimmer may result in serious personal injury.*
2. **Carry the hedge trimmer by the handle with the blade stopped and taking care not to operate any power switch.** *Proper carrying of the hedge trimmer will decrease the risk of inadvertent starting and resultant personal injury from the blades.*
3. **When transporting or storing the hedge trimmer, always fit the blade cover.** *Proper handling of the hedge trimmer will decrease the risk of personal injury from the blades.*
4. **When clearing jammed material or servicing the unit, make sure all power switches are off and the battery pack is removed or disconnected.** *Unexpected actuation of the hedge trimmer while clearing jammed material or servicing may result in serious personal injury.*
5. **Hold the hedge trimmer by insulated gripping surfaces only, because the blade may contact hidden wiring or its own cord.** *Blades contacting a "live" wire may make exposed metal parts of the hedge trimmer "live" and could give the operator an electric shock.*
6. **Keep all power cords and cables away from cutting area.** *Power cords or cables may be hidden in hedges or bushes and can be accidentally cut by the blade.*



- 7. Do not use the hedge trimmer in bad weather conditions, especially when there is a risk of lightning.** *This decreases the risk of being struck by lightning.*

### **Additional safety warnings for pole hedge trimmer**

- 1. To reduce the risk of electrocution, never use the pole hedge trimmer near any electrical power lines.** *Contact with or use near power lines may cause serious injury or electric shock resulting in death.*
- 2. Always use two hands when operating the pole hedge trimmer.** *Hold the pole hedge trimmer with both hands to avoid loss of control.*
- 3. Always use head protection when operating the pole hedge trimmer overhead.** *Falling debris can result in serious personal injury.*
- 4. Before operating the hedge trimmer, the user should make sure the locking device(s) of any moving elements (e.g. the extended shaft and pivoting element), if any, are in the locked position.**

### **Pruner safety warnings**

- 1. Interrupt your work when you feel tired or exhausted. Make regular breaks to regenerate.** *A moment of inattention while operating the product may result in serious personal injury.*
- 2. Keep all parts of the body away from the saw chain. Do not remove cut material or hold material to be cut when saw chain is moving. Make sure the switch is off when clearing jammed material.** *A moment of inattention while operating the product may result in serious personal injury.*
- 3. Hold the product by insulated gripping surfaces only, because the saw chain may contact hidden wiring or its own cord.** *Saw chains contacting a "live"*

## Safety warnings

---

- wire may make exposed metal parts of the product "live" and could give the operator an electric shock.*
4. **Keep cable away from cutting area.** *During operation the cable may be hidden in shrubs and can be accidentally cut by the blade.*
  5. **Keep all parts of the body away from the saw chain when the product is operating. Before you start the product, make sure the saw chain is not contacting anything.** *A moment of inattention while operating products may cause entanglement of your clothing or body with the saw chain.*
  6. **Always hold the product with both hands on the handle and soft grip.** *Holding the product with only one hand or on parts not intended for that increases the risk of personal injury and should never be done.*
  7. **Wear safety glasses and hearing protection. Further protective equipment for head, hands, legs and feet is recommended.** *Adequate protective clothing will reduce personal injury by flying debris or accidental contact with the saw chain.*
  8. **Do not operate a product in a tree.** *Operation of a product while up in a tree may result in personal injury.*
  9. **Always keep proper footing and operate the product only when standing on fixed, secure and level surface.** *Slippery or unstable surfaces such as ladders may cause a loss of balance or control of the product.*
  10. **When cutting a limb that is under tension be alert for spring back.** *When the tension in the wood fibres is released the spring loaded limb may strike the operator and/or throw the product out of control.*
  11. **Use extreme caution when cutting brush and saplings.** *The slender material may catch the saw chain and be whipped toward you or pull you off balance.*

12. **Carry the product by the soft grip with the product switched off and away from your body. When transporting or storing the product always fit the guide bar cover.** *Proper handling of the product will reduce the likelihood of accidental contact with the moving saw chain.*
13. **Follow instructions for lubricating, chain tensioning and changing accessories.** *Improperly tensioned or lubricated chain may either break or increase the chance for kickback.*
14. **Keep handles dry, clean, and free from oil and grease.** *Greasy, oily handles are slippery causing loss of control.*
15. **Cut wood only. Do not use product for purposes not intended. For example: do not use product for cutting plastic, masonry or non-wood building materials.** *Use of the product for operations different than intended could result in a hazardous situation.*
16. **Pay attention to national and local regulations.** *National and local regulations may restrict the use of this product.*
17. Only use replacement guide bars and saw chains specified by the manufacturer or equivalent replacements. Using non-approved cutting attachments can result in personal injuries and damage to property.
18. Before using the product and after any impact or dropping, check for signs of wear or damage and repair as necessary.
19. Never remove or modify any guard or safety component. Ensure that guards and other safety components necessary for machine operation are in position, in good working condition and properly maintained to avoid injuries.
20. Training of all operation is necessary for first-time and inexperienced operator.

## Safety warnings

---

21. Remove branches in section.
22. Use the harness provided.
23. Do not wear multiple belt harnesses and/or shoulder harnesses simultaneously.

### Causes and operator prevention of kickback

Kickback may occur when the nose or tip of the guide bar touches an object, or when the wood closes in and pinches the saw chain in the cut.

Tip contact in some cases may cause a sudden reverse reaction, kicking the guide bar up and back towards the operator.

Pinching the saw chain along the top of the guide bar may push the guide bar rapidly back towards the operator.

Either of these reactions may cause you to lose control of the saw which could result in serious personal injury. Do not rely exclusively upon the safety devices built into your saw. As a product user, you should take several steps to keep your cutting jobs free from accident or injury.

Kickback is the result of tool misuse and/or incorrect operating procedures or conditions and can be avoided by taking proper precautions as given below:

1. **Maintain a firm grip, with thumbs and fingers encircling the product handles, with both hands on the saw and position your body and arm to allow you to resist kickback forces.** *Kickback forces can be controlled by the operator, if proper precautions are taken. Do not let go of the product.*
2. **Do not overreach.** *This helps prevent unintended tip contact and enables better control of the product in unexpected situations.*

3. **Only use replacement bars and chains specified by the manufacturer.** *Incorrect replacement bars and chains may cause chain breakage and/or kickback.*
4. **Follow the manufacturer's sharpening and maintenance instructions for the saw chain.** *Decreasing the depth gauge height can lead to increased kickback.*

### **Additional safety warnings for battery pack**

1. **Battery pack needs to be charged before use.** *Always refer to the charger's instruction and charge it properly.*
2. **Remove the battery pack from the product when not in use.**
3. **Don't maintain the battery pack on the charger when not in use.**
4. **After extended periods of storage, it may be necessary to charge and discharge the battery pack several times to obtain the maximum performance.**
5. **Longer life and better performance can be obtained if the battery is charged when the air temperature is between 18 °C and 24 °C.** *Do not charge the battery in air temperature below 5 °C or above 40 °C. This is important as it can prevent serious damage to the battery.*
6. **Do not charge battery in a damp or wet location.** *Following this rule will reduce the risk of electric shock.*
7. **Do not disassemble the battery and avoid mechanical damage to the battery.** *Risk of short circuit and fumes may be emitted. Ensure fresh air and seek medical assistance in the event of discomfort.*
8. **When disposing of battery pack, keep the battery pack of different electrochemical systems separate from each other.**

## Safety warnings

---

### **Vibration and noise reduction**

**To reduce the impact of noise and vibration emission, limit the time of operation, use low-vibration and low-noise operating modes as well as wear personal protective equipment.**

Take the following points into account to minimise the vibration and noise exposure risks:

1. Only use the product as intended by its design and these instructions.
2. Ensure that the product is in good condition and well maintained.
3. Use correct attachments for the product and ensure they are in good condition.
4. Keep tight grip on the handles/grip surface.
5. Maintain this product in accordance with these instructions and keep it well lubricated (where appropriate).
6. Plan your work schedule to spread any high vibration tool use across a longer period of time.
7. Prolonged use of the product exposes the user to vibrations that can cause a range of conditions collectively known as hand-arm vibration syndrome (HAVS) e.g. fingers going white; as well as specific diseases such as carpal tunnel syndrome. To reduce this risk when using the product, always wear protective gloves and keep your hands warm.

## Emergency

**Familiarise yourself with the use of this product by means of this instruction manual. Memorise the safety directions and follow them to the letter. This will help to prevent risks and hazards.**

- 1. Always be alert when using this product, so that you can recognise and handle risks early.** *Fast intervention can prevent serious injury and damage to property.*
- 2. Switch the product off and remove the battery pack if there are malfunctions.** *Have the product checked by a qualified professional and repaired, if necessary, before you operate it again.*

## Residual risks

**Even if you are operating this product in accordance with all the safety requirements, potential risks of injury and damage remain. The following dangers can arise in connection with the structure and design of this product:**



1. Health defects resulting from vibration emission if the product is being used over long periods of time or not adequately managed and properly maintained.
2. Injuries and damage to property due to broken attachments or the sudden impact of hidden objects during use.
3. Danger of injury and property damage caused by flying objects.



**WARNING!** This product produces an electromagnetic field during operation! This field may under some circumstances interfere with active or passive medical implants! To reduce the risk of serious or fatal injury, we recommend persons with medical implants to consult their doctor and the medical implant manufacturer before operating this product!

## Symbols

On the product, the rating label and within these instructions you will find among others the following symbols and abbreviations. Familiarise yourself with them to reduce hazards like personal injuries and damage to property.

	Volt, (direct current voltage)	mAh	Milliampere per hour
/min or min <sup>-1</sup>	Per minute	°C	Degree Celsius
g	Gram	kg	Kilogram
mm	Millimetre	m	Metre
cm	Centimeter	m/s <sup>2</sup>	Metres per second squared
dB(A)	Decibel (A-rated)		
	Lock / to tighten or secure.		Unlock / to loosen.



Read the instruction manual.



Note / Remark.



Caution / Warning.

xxWyy Manufacturing date code; year of manufacturing (20xx) and week of manufacturing (Wyy)



Wear hearing protection.



Wear eye protection.



Wear a dust mask.



Wear protective gloves.



Wear head protection, where there is a risk of falling objects.



Wear Face protection.



Wear protective, slip-resistant footwear.



Wear tight-fitted protective clothes.



Switch the product off and remove battery pack before assembly, cleaning, adjustments, maintenance, storage and transportation.



This product is of protection class III.





Do not expose the product to rain or wet conditions (moisture).



Keep hands away from moving cutting device!



Objects thrown by the product could hit the user or other bystanders. Always ensure that other people and pets remain at a safe distance from the product when it is in operation. In general, children must not come near the area where the product is.



Minimum distance is 15m.

Warning! Danger from overhead electric-power lines! Keep at least 10m distance.



**Kickback!** Tip contact may cause the guide bar to move suddenly upward and backwards what may cause serious injury to user.



Contact of the guide bar tip with any object should be avoided.



Always use the product with two hands. Do not use one handed when operating the product.



Chain oil fill.



Correct direction of cutting-teeth.



Cutting of fingers or hand.



Danger of falling objects.



Guaranteed sound power level value in 96 dB.



WEEE symbol. Waste electrical products should not be disposed of with household waste. Please recycle where facilities exist. Check with your Local Authority or local store for recycling advice.



Crossed out dust bin. Batteries and battery packs should not be disposed of with household waste. Please recycle where facilities exist. Check with your Local Authority or local store for recycling advice.

## Symbols

---



Do not dispose of battery packs in rivers or immerse in water.



Do not dispose of battery packs in fire. They will explode and cause injury.



Do not expose battery packs to heat in excess of 40 °C.  
Do not charge or store the battery pack in temperatures below 5 °C (41 °F) and above 40 °C (104°F).



The product complies with the applicable European directives and an evaluation method of conformity for these directives was done.



UK Conformity Assessed.

## Your product

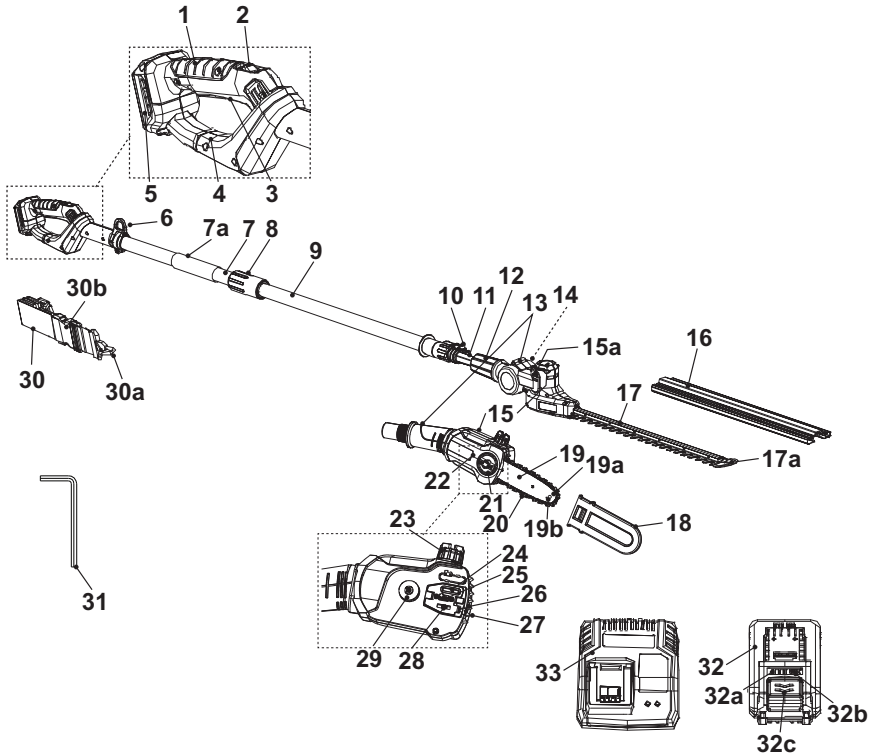

- |   |   |                                |
|---|---|--------------------------------|
| 1. Rear handle                          | a. Bore (x2)*                           | 25. Mounting bolt              |
| 2. Lock-off button                      | 14. Unlock button for angle adjustment* | 26. Tension screw              |
| 3. On/off switch                        | 15. Motor head                          | 27. Spiked bumper              |
| 4. Rear safeguard                       | a. Air vents*                           | 28. Tension pin                |
| 5. Battery docking port                 | 16. Blade cover                         | 29. Drive sprocket             |
| 6. Loop                                 | 17. Hedge trimmer blade                 | 30. Harness                    |
| 7. Rear pole                            | a. Blade tip protector                  | a. Securing clip               |
| a. Soft grip                            | 18. Guide bar cover                     | b. Quick release               |
| b. Slot*                                | 19. Guide bar                           | 31. Multi-tool                 |
| 8. Inter-locking sleeve                 | a. Sprocket wheel                       | 32. Battery pack               |
| a. Electrical cord*                     | b. Lubrication hole                     | a. Battery capacity indicators |
| 9. Front pole                           | 20. Saw chain                           | b. Battery capacity button     |
| 10. Locking lever for length adjustment | 21. Locking wheel                       | c. Release button              |
| 11. Pole extension                      | 22. Chain saw cover                     | 33. Charger                    |
| a. Lock pin (x2)*                       | 23. Oil tank cap                        |                                |
| 12. Locking sleeve                      | a. Oil level window*                    |                                |
| 13. Pole support                        | 24. Oiling port                         |                                |

## Your product



**NOTE:** Parts marked with \* are not shown in this overview. Please refer to the respective part in the instruction manual.

## Unpacking

1. Unpack all parts and lay them on a flat, stable surface.
2. Remove all packing materials and shipping devices if applicable.
3. Make sure the delivery contents are complete and free of any damage. If you find that parts are missing or show damage do not use the product but contact your dealer. Using an incomplete or damaged product represents a hazard to people and property.
4. Ensure that you have all the accessories and tools needed for assembly and operation. This also includes suitable personal protective equipment.



**WARNING!** The product and the packaging are not children's toys! Children must not play with plastic bags, sheets and small parts! There is a danger of choking and suffocation!

## You will need

(items not supplied)

Suitable personal protective equipment  
 Suitable hex key  
 Lubricant for blade

(items supplied)

Blade cover (16)  
 Guide bar cover (18)  
 Harness (30)  
 Multi-tool (31)  
 Battery pack (32)  
 Charger (33) and its manual



**NOTE:** The accessories required depend on the intended application. Ask your dealer for advice.

## Setup



**WARNING!** The product must be fully assembled before operation! Do not use a product that is only partly assembled or assembled with damaged parts!



Follow the assembly instructions step-by-step and use the pictures provided as a visual guide to easily assemble the product! Before using the product, familiarise yourself with the operating features read the entire instruction manual paying particular attention to the safety rules and operating procedures.

Do not connect the product to battery pack (32) before it is completely assembled!

### Pole assembly

1. Align the slot (7b) of the rear pole (7) with the spigot inside the front pole (9) and insert it (Fig. 1, step 1). Make sure that the electrical cord (8a) is not squeezed.
2. Fit the inter-locking sleeve (8) on the thread of front pole (9) and tighten the inter-locking sleeve (8) clockwise to secure the connections (Fig. 1, step 2).

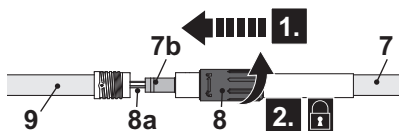

Fig. 1

### Assembly of cutting unit

Choose and assemble the suitable cutting unit to fit the intended use. There are two cutting units delivered for use, one is hedger trimmer cutting unit and the other is pruner cutting unit.

1. Loosen the locking lever (10) (Fig. 2, step 1) and pull out the pole extension (11) (Fig. 2, step 2), then fasten the locking lever (10) (Fig. 2, step 3).
2. Move the locking sleeve (12) back onto the pole extension (11) (Fig. 2, step 4).
3. Choose one suitable cutting unit, then align the pole extension (11) with the pole support (13) and insert it. Make sure the pins (11a) snaps in the bores (13a) for reliable connection (Fig. 2, step 5).
4. Fit the locking sleeve (12) on the thread of pole support (13) and tighten the locking sleeve (12) clockwise to secure the connections (Fig. 2, step 6).

## Setup

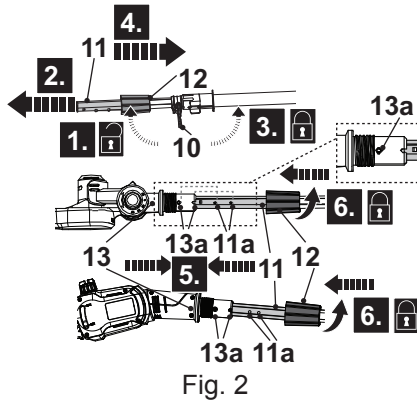

Fig. 2

### Blade cover

1. Remove the blade cover (16) from the hedge trimmer blade (17) before operation (Fig. 3).
2. Keep the blade cover (16) safely.
3. The pole hedge trimmer is ready for use.

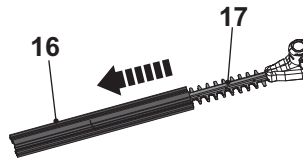

Fig. 3



**NOTE:** Always attach the blade cover (16) when the product is not in use, for storage and transportation.

To attach the blade cover (16), align and push the blade cover onto the hedge trimmer blade (17).

### Guide bar cover

1. Remove the guide bar cover (18) from the saw chain (20) and the guide bar (19) before operation (Fig. 4).
2. Keep the guide bar cover (18) safely.
3. The pole pruner is ready for use.

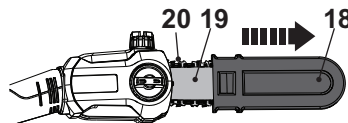

Fig. 4

## Saw chain and guide bar

The saw chain (20) and the guide bar (19) are pre-assembled on the pruner cutting unit. The user can re-assemble them with the new ones, if necessary.

1. Place the product on a suitable flat surface with the chain saw cover (22) facing forwards.
2. Unscrew the locking wheel (21) anticlockwise and then remove it together with the chain saw cover (22), the guide bar (19) and the saw chain (20) (Fig. 5).
3. Use the new guide bar (19) and saw chain (20) with same types described in the “technical specification”.
4. Spread the saw chain (20) out with the cutting edges of the chain pointing in the direction of rotation. Slide the saw chain (20) into the groove around the guide bar (19). Ensure saw chain (20) is installed in correct direction of rotation (Fig. 6).

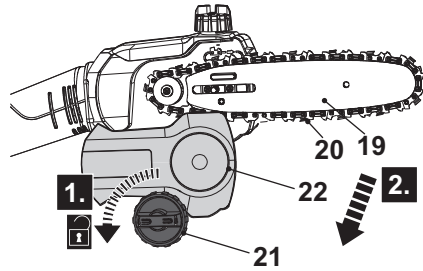

Fig. 5

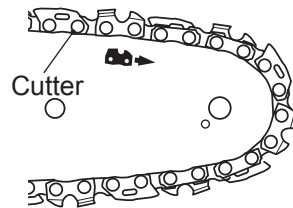

Fig. 6



**WARNING!** The direction of the saw chain ‘cutters’ must be same as indicated by the symbol and arrow on the guide bar!

5. Align the saw chain (20) and the guide bar (19) assembly with the drive sprocket (29) and the mounting bolt (25). Lay the saw chain (20) around the drive sprocket (29) and then lower the guide bar (19) to install it to the mounting bolt (25) (Fig. 7).
6. Make sure the tension pin (28) is inserted into the lower hole on the guide bar (19). Screwing the tension screw (26) with the multi tool (31) in or out to adjust the position of the tension pin (28) if necessary.

# Setup

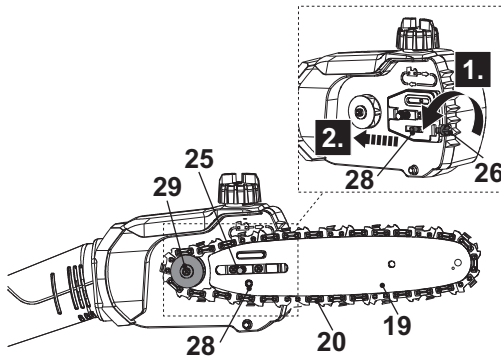

Fig. 7

7. The saw chain movement is as indicated by the arrow. Make sure the saw chain (20) is properly placed over the sprocket wheel (19a) of the guide bar (19) (Fig. 8).

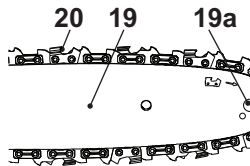

Fig. 8



**WARNING!** The direction of the saw chain 'cutters' must be same as indicated by the symbol and arrow on the guide bar! Ensure the guide bar and saw chain are properly assembled in correct direction; otherwise the saw chain cannot work.

8. Screw the tension screw (26) with the multi tool (31) clockwise out to adjust the tension pin (28) / guide bar (19) towards the right to tighten the saw chain (20) (Fig. 9).

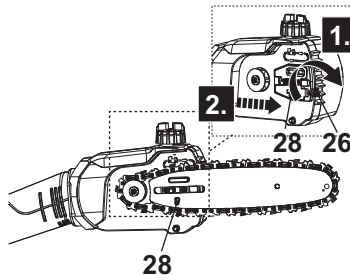

Fig. 9



- Refit the chain saw cover (22) and slightly tighten the locking wheel (21) clockwise (Fig. 10). Do not tighten the locking wheel (21) completely as saw chain tensioning is required first.

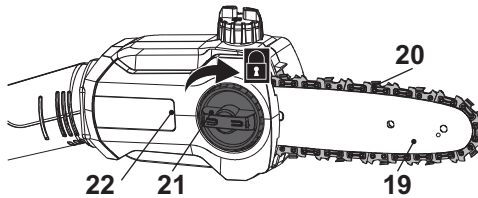

Fig. 10



**NOTE:** The saw chain (20) has not yet been tensioned. Tension the chain as described under “Saw chain tensioning”. After operating the product for approx. 1 hour, adjust the chain tension again.

### Saw chain tensioning

Always check the saw chain tension before use, after the first cuts and regularly during use, approx. every five cuts. Upon initial operation, new chains can lengthen considerably. This is normal during the break-in period and the interval between future adjustments will lengthen quickly.



**WARNING!** Disconnect the product from the power supply before adjusting saw chain tension!



The cutting edges of the saw chain are sharp! Always wear protective gloves when handling chain!



Always maintain proper chain tension! A loose chain increases the risk of kickback! A loose chain may jump out of the guide bar groove! This may injure the operator and damage the chain! A loose chain will cause rapid wear to the chain, guide bar and sprocket!

Tensioning the chain too tightly will overload the motor and cause damage, and insufficient tension can cause chain derailing, whereas a correctly tightened chain provides the best cutting characteristics and prolonged working life! The chain life mainly depends upon sufficient lubrication and correct tensioning!

- Place the product on a suitable flat surface with the chain saw cover (22) facing forwards.
- Check the chain tension using one hand to lift the saw chain (20) against the weight of the product. The correct chain tension is achieved when the saw chain can be lifted by approximately 2 - 4 mm from the guide bar (19) in the centre (Fig.11, 12).

## Setup

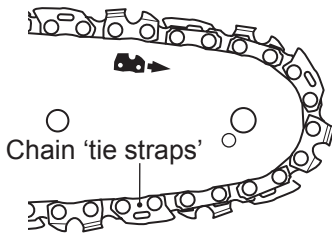

Fig. 11

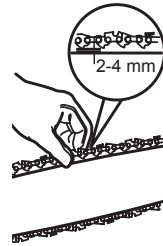

Fig. 12

3. Adjust the tension if you find that the saw chain (20) is too loose or tight.
4. Slightly loosen the locking wheel (21), then screw the tension screw (26) with the multi tool (31) in or out to adjust the tension pin (28) / guide bar (19) towards the left or right until the chain 'tie straps' are just touching the bottom edge of the guide bar (19), hold it in the position.
5. Pull the saw chain (20) along the top of the guide bar (19) by gloved hand from one end to the other, several times. The saw chain (20) should feel tight but still move freely.
6. After the adjustment, re-tighten the locking wheel (21).

## Chain lubrication



**WARNING!** The product is not filled with chain oil. It is essential to fill the product with chain oil before using it! Never operate the product without chain oil as this will result in extensive damage to the product! Operating the saw chain dry or with too little chain oil will decrease cutting efficiency, shorten the product life span and cause rapid wear to the saw chain and guide bar from overheating! Insufficient chain oil is evident by smoke or bar discoloration! Adequate lubrication of the saw chain during cutting operations is essential to minimise friction with the guide bar!

1. Place the product on a stable, level surface with the oil tank cap (23) facing upward. We recommend laying a non-flammable sheet under the product.
2. Unscrew and remove the oil tank cap (23) (Fig. 13).

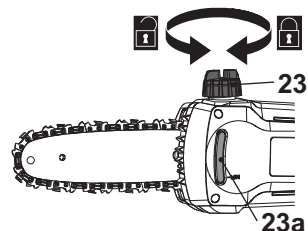

Fig. 13

- Fill suitable lubricant into the tank using an oil funnel fitted with a filter to avoid debris entering the tank. We recommend using environmentally friendly chain oil specially intended to be used with this product.



**NOTE:** In summer use SAE #30; in winter, or if the trees have excessive sap, use SAE #10.

- Don't fill the oil lower than the "MIN" mark on the oil level window (23a), but also do not overfill or and leave approximately 5 mm of space between the top of the oil and the inside edge of the tank to allow for expansion (Fig. 14).

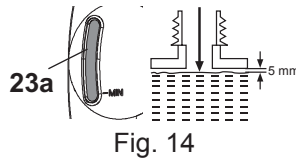

Fig. 14



**NOTE:** Towards the end of the season, it is advisable to put only as much lubricant in the tank as you need for each cut, so that it is completely used up before you store the product.

- Check the oil level window (23a) prior to start-up and regularly during operation. Refill oil when the oil level is close to the bottom of the oil level window (23a) (Fig. 14).
- Wipe up spilled lubricant with a soft cloth and refit the oil tank cap (23).



**NOTE:** Always dispose of lubricant, used oil and objects contaminated with them in accordance with local regulations.

## Checking



**NOTE:** Perform the following test before operating your product. This product is equipped with an automatic oiling system. The oiling system automatically delivers the proper amount of oil to the bar and chain.

Checking the lubrication requires starting the product. Before checking, the product must be fully assembled and all instructions must have been read.

## Chain lubrication

1. Make sure the guide bar (19) and the saw chain (20) are in place when you check the oil delivery.
2. Start the product; keep it running at no load and check if the chain oil is delivered as shown in the figure (Figs.15, 16).

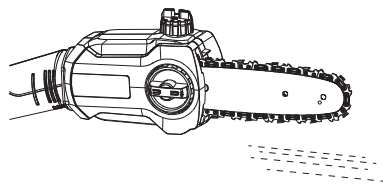

Fig. 15

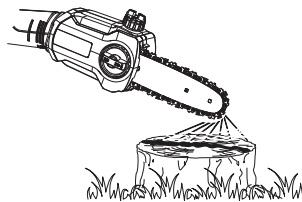

Fig. 16

## Battery pack

### Attaching / releasing the battery pack

1. Align the battery pack (32) with the sliding slots of the battery docking port (5) and slide the battery pack in to attach it. Ensure it clicks in place (Fig. 17).
2. Press the release button (32c) and remove the battery pack (32) from the battery docking port (5) (Fig. 18).

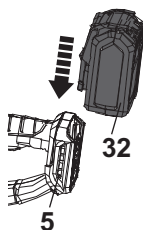

Fig. 17

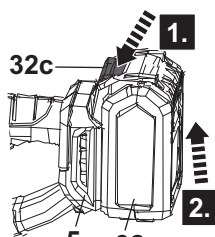

Fig. 18

### Charging the battery pack

The battery pack (32) for this product has been shipped in a low charge condition. Charge it fully before first use.

Refer to the charger's instruction manual (TTB805CHR) for the details.

## Battery capacity indicators

The battery pack (32) is equipped with the battery capacity indicators (32a) which are used to give an indication of the battery pack's remaining capacity. Press the battery capacity button (32b) to check battery capacity (Fig. 19). The LEDs will stay lit for approximately 5 seconds.

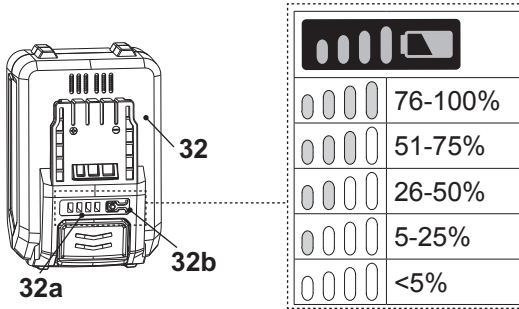

Fig. 19

# In more detail...



<b>Product functions</b>	31
<b>Operation</b>	35
<b>Care and maintenance</b>	42
<b>Troubleshooting</b>	48
<b>Recycling and disposal</b>	49
<b>Guarantee</b>	50
<b>Technical specifications</b>	52
<b>Declaration of conformity</b>	55



## Intended use

This cordless hedge trimmer TTT831HDC-Li is designated with a rated voltage of 18 V . It is designed only to be used with the battery pack which is listed in the chapter of "Technical specifications".

The product is intended for cutting and trimming of hedges, bushes and shrubs in domestic gardens when assembled with hedge trimmer cutting unit. The maximum cutting capacity must be observed. Do not cut branches exceeding the stated maximum capacity.

The product is intended for cutting limbs with a thickness of max. 180mm when assembled with pruner cutting unit. It must not be used for cutting other materials, such as plastic, stone, metal or wood that contains foreign objects. The product may only be used with the guide bar/saw chain combination stated in these instructions. It is not permitted to use other types or sizes.

Vertical and horizontal cuts can be performed with this product. Longitudinal sections can only be cut by professionals.

This product should not be used outside of domestic premises e. g. for cutting firewood in forested areas.

The use of this product in case of rain or humid environment is prohibited. For safety reasons it is essential to read the entire instruction manual before first operation and to observe all the instructions therein.

This product is intended for private domestic use only, not for any commercial trade use. It must not be used for any purposes other than those described.

## Harness

The harness (30) helps the operator to carry the product.

1. Place the harness (30) so that it runs over the left shoulder, crossing the chest and back. The securing clip (30a) must be located at the right hip. The quick release (30b) must be in front (Fig. 20).
2. Adjust the length of the harness (30) so that the securing clip (30a) is approximately 15 cm below your waist.
3. Attach the securing clip (30a) to the loop (6) (Fig. 21).
4. Lock the harness (30) onto the loop (6) by the securing clip (30a) (Fig. 22).

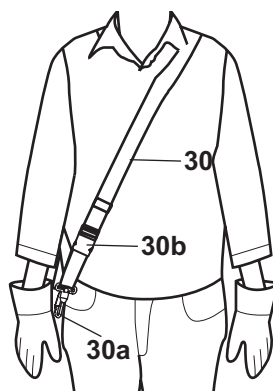

Fig. 20

## Harness

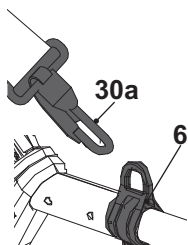

Fig. 21

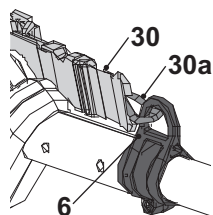

Fig. 22



**WARNING!** Always attach the product to the harness (30). Do not carry it only with your hands!

- In case of emergency hold the soft grip (7a) of the rear pole (7) with the left hand, and use the right hand to press two clips of the quick release (30b). The product together with the securing clip (30a) will be released automatically from the body because of the weight of the product (Fig. 23).

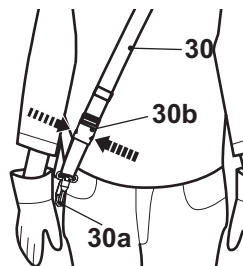

Fig. 23

## Length adjustment

- Loosen the locking lever (10) (Fig. 24, step 1).
- Adjust to the required length by pulling out or pushing in the pole extension (11) (Fig. 24, step 2).



**WARNING!** The length of the extension pole is limited! Stop pushing/pulling as soon as you feel a resistance! Extend the extension only to the length required to reach the hedges being trimmed! Do not attempt to use the product at a length which does not allow you to achieve proper footing and balance at all times!

- Secure the position of pole extension (11) by fastening the locking lever (10) back to its original position (Fig. 24, step 3).



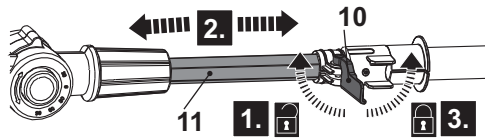

Fig. 24

## Angle adjustment

The angle of the blade head for hedge trimmer cutting unit can be adjusted into five positions (Fig. 25):

1. Press the unlock button (14) to unlock the angle adjustment and hold it in position.
2. Adjust the blade head to the desired position by swing the pole support (13).
3. Release the unlock button (14) and keep moving the pole support (13) until it locks in place.
4. Ensure the unlock button (14) snaps in place before operation.

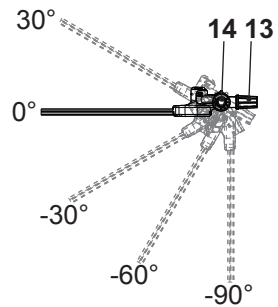

Fig. 25



**WARNING!** The blade head for pole hedge trimmer can be adjusted in five different positions.

Always ensure the blade head is securely locked! Do not attempt to use the product with the head in an intermediate position!

## Switching on/off

1. Ensure the hedge trimmer blade (17) or the saw chain (20) does not touch any objects. Remove the blade cover (16) or the guide bar cover (18) from the hedge trimmer blade (17) or the saw chain (20) before switching the product on.
2. Hold the product with one hand on the soft grip (7a) of the rear pole (7) and the other hand on the rear handle (1). Do not start the product while handling it with one hand.
3. Pull back the lock-off button (2) and hold it in position (Fig. 26, step 1).
4. Squeeze the on/off switch (3) to switch the product on (Fig. 26, step 2). Release the lock-off button (2) afterwards.
5. Release the on/off switch (3) to switch the product off.

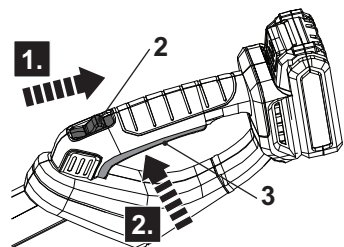

Fig. 26

## Switching on/off



**WARNING!** The product will continue to work for some time even after the motor has been switched off! Wait until it comes to a complete stop before you put the product down!

## Saw chain stop test



**NOTE:** Perform the following test before operating your product when assembled of pruner cutting unit.

1. Hold the product with one hand on the soft grip (7a) of the rear pole (7) and the other hand on the rear handle (1).
2. Ensure the saw chain (20) does not come into contact anything when switching on.
3. Release the on/off switch (3) to switch the product off, the saw chain must come to a stop.



**WARNING!** If the saw chain shows any signs of moving, stop the motor immediately! Wait for all moving parts to stop! Contact a qualified specialist to have a check!

## General operation

1. Check the product, its battery pack and charger as well as accessories for damage before each use. Do not use the product if it is damaged or shows wear. Take care of any problem you find or have the product checked by qualified specialist.
2. Double check that the accessories and attachments are properly fixed.
3. Check the chain oil level, refill if necessary.
4. Always hold the product on its handles. Keep the handles dry to ensure safe support.
5. Ensure that the air vents are always unobstructed and clear. Clean them if necessary with a soft brush. Blocked air vents may lead to overheating and damage the product.
6. Switch the product off immediately if you are disturbed while working by other people entering the working area. Always let the product come to complete stop before putting it down.
7. Do not overwork yourself. Take regular breaks to ensure you can concentrate on the work and have full control over the product.
8. Before switching the product on, check whether it has been assembled correctly and all the moving parts are running smoothly!
9. While working, ensure that the product does not strike hard objects, as this can cause damage.

## Trimming times

green leaf hedges	June to October
evergreens	April and August
conifers and other fast growing shrubs	every 6 - 8 weeks

## Trimming



**NOTE:** Try to keep the cutting device angled at approximately 15° to the cutting surface.

1. Make sure that the blade cover (16) is removed, and the battery pack (32) is assembled before operation.
2. Ensure that no people or animals are in the work area.
3. Adjust the product to a suitable pole length and blade head angle.
4. Cut and remove branches exceeding the cutting capacity of this product using a proper pruner before operation.

## Trimming

5. Always hold the product firmly with both hands on soft grip (7a) of the rear pole (7) and the rear handle (1). Never operate this product using only one hand.
6. Do not rush and do not attempt to cut too much with one stroke of the cutting device.
7. First cutting both sides from the bottom upwards to the top. This will prevent any of the cuttings falling into the path of the area still to be cut (Fig. 27).
8. After cutting the sides proceed to the top. Try to keep the cutting device angled at approximately  $15^\circ$  to the cutting surface (Fig. 28).

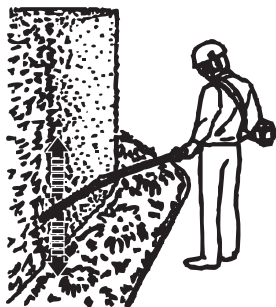

Fig. 27

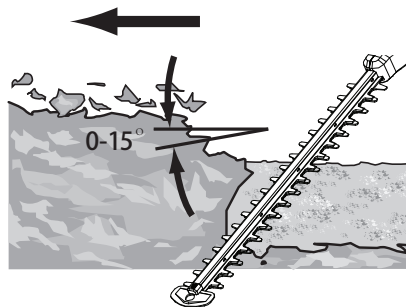

Fig. 28

9. When cutting wide hedges with the cutting area in sight move the cutting blade lightly through the cutting surface in a sweeping motion following the shape of the hedge or shrub. A slight tilt downwards of the cutting blade in the direction of motion is recommended for optimum cutting performance.
10. Cut in a number of stages to achieve a better result rather than trying to cut in one go if the area being cut is particularly long (Fig. 29); smaller cuttings will allow for easy composting.
11. Move the product with slow motion forward when cutting higher hedge and the cutting area out of sight (Fig. 30).



Fig. 29

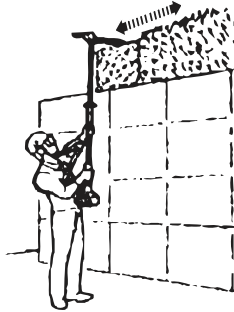

Fig. 30



**NOTE:** When shaping it is advisable to achieve a trapezoidal shape (Fig. 31). A trapezoidal cut corresponds to the natural growth of plants and results in optimal hedge growth, as it will expose more light to the lower end of the hedge.

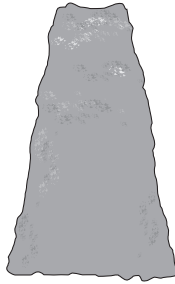

Fig. 31

12. Lubricate the internal surfaces of the blade if the hedge trimmer blade (17) overheats during operation (Fig. 32).



**WARNING!** This operation must only be performed when the blades have stopped running and the product is switched off!

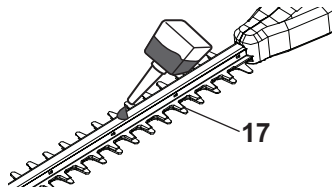

Fig. 32

## Pruning times

Only operate the product at reasonable hours - not early in the morning, late at night or on weekends/public holidays when people might be disturbed. Inform yourself about local restrictions.

## Pruning

### Kickback



**WARNING!** Beware of kickback! Kickback can lead to dangerous loss of control of the product and result in serious or fatal injury to the operator or anyone standing close by! Always be alert because rotational kickback and pinch kickback are major product operational dangers and the leading cause of most accidents!

1. Kickback is the sudden backward/upward motion of the product, occurring when the chain (at the tip of the chain bar) comes in contact with a log or wood, or when the chain becomes jammed.
2. When kickback occurs the product reacts unpredictably and can cause severe injuries to the operator or bystanders.
3. With a basic understanding of 'kickback', the element of surprise can be reduced or eliminated. Sudden surprise contributes to the majority of accidents.
4. You should read all the safety warnings and user instructions carefully before attempting to operate this product.

### To avoid kickback:

- Never work with a loose, widely stretched or heavily worn chain.
- Always use a low kickback chain.
- Ensure correct chain tension.
- Ensure the chain is sharpened correctly.
- Never work with the tip of the guide bar.
- Saw with the guide bar at a flat angle.
- Always hold the product firmly with both hands.

### Pruning

1. Make sure that the guide bar cover (18) is removed, and the battery pack (32) is assembled before operation.
2. Adjust the product to a suitable pole length.
3. Always hold the product firmly with both hands on soft grip (7a) and rear handle (1). Never operate this product using only one hand (Fig. 33).
4. Maintain a firm grip with your thumbs and fingers encircling the handles. A firm grip will help you reduce 'kickback' and maintain control of the product.
5. Always hold the product at an angle of not more than 60° from the horizontal level. Otherwise safe operation is not possible (Fig. 34).

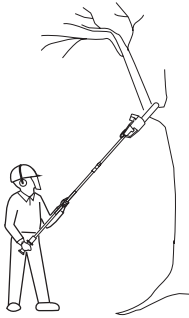

Fig. 33

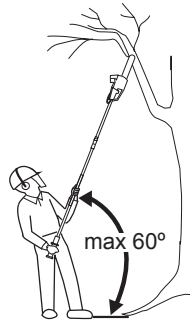

Fig. 34

6. Never stand directly under the limb you are sawing. Objects may fall different than expected. Always position yourself out of the path of falling limbs (Fig. 35).
7. Keep other persons away from cutting end of product and at a safe distance from the work area. Maintain a minimum distance of 10 m to bystanders (Fig. 36).

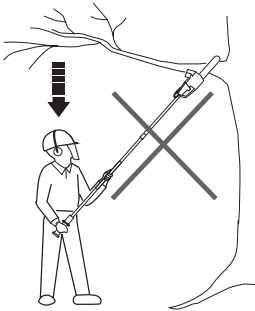

Fig. 35

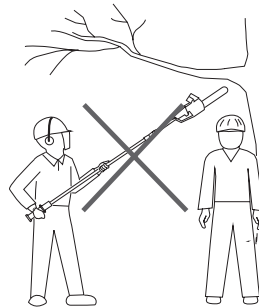

Fig. 36



**WARNING!** Never climb into a tree to prune! Do not stand on ladders, platforms, logs, or in any position which may cause you to lose your balance or control of the product! When pruning trees, it is important not to make the flush cut next to main limb or trunk until you have cut off the limb further out to reduce the weight! This prevents stripping the bark from the main member!

8. Never stand on a ladder or other type of unstable support while using the product. Insecure stand invites hazards (Fig. 37).

## Pruning

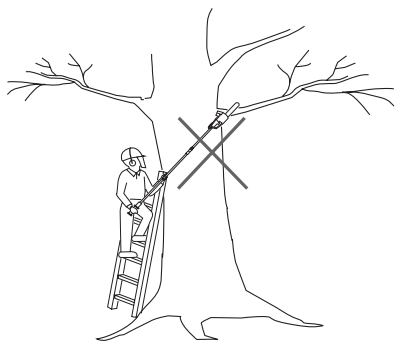

Fig. 37

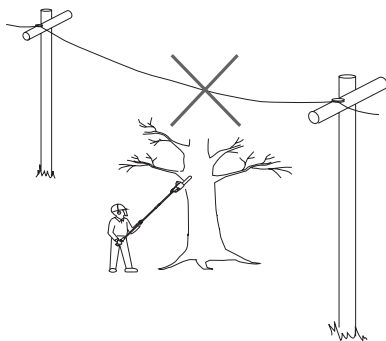

Fig. 38



**WARNING!** This product has not been designed to provide protection from electric shock in the event of contact with overhead electric lines! Therefore do not use product near cable, electric power or telephone lines. Keep a minimum distance of 10 m to all electric lines (Fig. 38).

9. Use the product only with secure footing. Hold the product at the right-hand side of your body. Regularly change the working position and include rest periods during operation.
10. Do not operate the product with arms fully extended or attempt to cut areas which are difficult to reach.
11. Keep a firm, steady pressure on the product while working with it. Do not try to force the product through the wood, let the cutting device do the work, using the gripping teeth to apply minimal leverage pressure.
12. Beware when reaching the end of the cut. The weight of the product may change unexpectedly as it cuts free from the wood. Accidents can occur to the legs and feet. Always remove the product from a wood cut while it is running.



**NOTE:** The chain must be running at full speed before it comes into contact with the wood.

### Thin branches

Thin branches can be cut off with one single cut. To prevent the branch from splintering and buckling the branch should be cut off in several pieces (Fig. 39).





Fig. 39

### Thick branches

When cutting off larger branches three cuts are necessary.

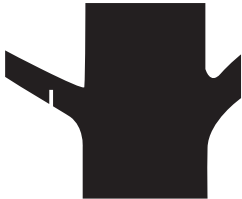

Fig. 40



Fig. 41



Fig. 42

1. First cut into the branch from below outside the place where you intend to cut off the branch. The cut should go from one third to halfway through the branch (Fig. 40).
2. Cut into the branch from the top outside at the same height the branch is sawn from top (Fig. 41).
3. Last, cut off the stump with one clean cut from top to bottom (Fig. 42).
4. You might want to seal the cut with a suitable compound.



**NOTE:** Remove the branches lying on the floor regularly to avoid stumbling hazards. Check the oil level regularly and fill up if necessary. Switch the power off and disconnect from power source when leaving the product.

## After use

1. Switch the product off, remove the battery back and let it cool down.
2. Attach the blade cover (16) to the hedge trimmer blade (17) if necessary.
3. Attach the guide bar cover (18) to the saw chain (20) if necessary.
4. Check, clean and store the product as described below.

## The golden rules for care



**WARNING!** Always switch the product off, remove the battery pack (32) and let the product cool down before performing inspection, maintenance and cleaning work!



1. Keep the product clean. Remove debris from it after each use and before storage.
2. Regular and proper cleaning will help ensure safe use and prolong the life of the product.
3. Inspect the product before each use for worn and damaged parts. Do not operate it if you find broken and worn parts.



**WARNING!** Only perform repairs and maintenance work according to these instructions! All further works must be performed by a qualified specialist!

## General Cleaning

1. Clean the product with a damp cloth and pH-neutral soap. Use a brush for areas that are hard to reach.
2. In particular clean the air vents (15a) after every use with a cloth and brush.
3. Remove stubborn dust with high pressure air (max. 3 bar).



**NOTE:** Do not use chemical, alkaline, abrasive or other aggressive detergents or disinfectants to clean this product as they might be harmful to its surfaces.

4. Check for any damage and wear. Repair damages in accordance with this instruction manual or take it to an authorised service centre before using the product again.

## Hedge trimmer blade



**WARNING!** Wear safety gloves when working on the cutting device and close to it! Use appropriate tools to remove debris, e. g. a brush or wooden stick! Never use your bare hands!



1. Keep the hedge trimmer blade (17) clean and free of debris. Remove trimmings with a brush.
2. Apply a small amount of suitable lubricant on the hedge trimmer blade (17) to retain a good cutting performance (Fig. 32).

## Sprocket wheel



**NOTE:** It is not necessary to remove the saw chain (20) to lubricate the sprocket wheel (19a). Lubrication can be done on the job.

1. Clean the sprocket wheel (19a).
2. Using a disposable lube gun, insert the needle nose into the lubrication hole (19b) (Fig. 43) and inject grease until it appears at the outside edge of the sprocket wheel (19a).

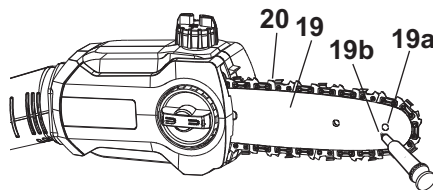

Fig. 43

3. Rotate the saw chain (20) by hand. Repeat the lubrication procedure until the entire sprocket wheel (19a) has been greased.

## Guide bar and saw chain maintenance

### Guide bar

Most guide bar problems can be prevented merely by keeping the product well maintained. Incorrect filling and non-standard cutter and depth gauge settings are the causes of most guide bar problems, primarily resulting in uneven bar wear.

As the bar wears unevenly, the rails widen, which may cause the chain to clatter and make it difficult to complete straight cuts. If the guide bar is insufficiently lubricated and the product is operated with a saw chain which is too tight, this will contribute to rapid bar wear. To help minimise bar wear, maintenance of the guide bar as well as the saw chain is recommended.

1. Disassemble the guide bar (19) and saw chain (20) in reversed order from assembly.
2. Check the oiling port (24) for clogging and clean if necessary to ensure proper lubrication of the guide bar and saw chain during operation. Use a soft wire small enough to insert into the oil discharge hole (Fig. 44).

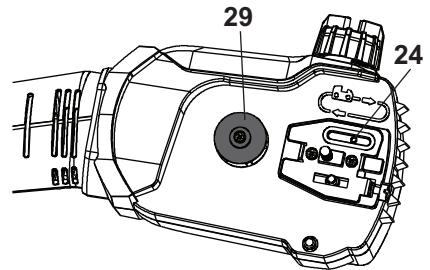

Fig. 44



**NOTE:** The condition of the oil passages can be easily checked. If the passages are clear, the chain will automatically give off a spray of oil within seconds of the product starting. Your product is equipped with an automatic oiling system.

3. Check the drive sprocket (29). If it is worn or damaged due to strain, have it replaced by an authorised service agent.
4. Clear residue from the rails on the guide bar (19) by using a screwdriver, putty knife, wire brush or other similar tool. This will keep the oil passages open to provide proper lubrication to the guide bar (19) and saw chain (20) (Fig. 45).

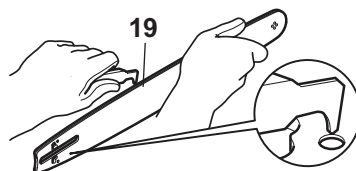

Fig. 45

5. Check the guide bar 'rail' for wear: Hold a ruler (straight edge) against the side of the guide bar and 'cutter side plates'. If there is a gap between the ruler and guide bar the guide bar 'rail' is normal. If there is no gap (ruler flush against the side of the guide bar) the guide bar 'rail' is worn and needs to be replaced with a new one of the same type (Fig. 46).

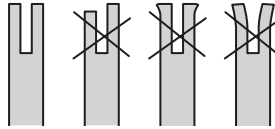

Fig. 46

6. Check the saw chain for possible wear and damages. Replace it with a new one if required. Experienced user can sharpen a dull saw chain (see section "Saw chain sharpening" below).
7. Refit the saw chain (20) and the guide bar (19) as described under "Assembly".

### Saw chain sharpening



**NOTE:** Never saw with a blunt chain. The saw chain is blunt if you have to push the product into the tree and the chips are very small.

1. Have the saw chain (20) sharpened professionally at an authorised service centre or sharpen the chain yourself by using a proper sharpening kit. Also observe the sharpening instructions supplied with the sharpening kit.



**WARNING!** Only sharpen the saw chain yourself if you are trained and have experience! Use proper tools to sharpen the saw chain!

2. The height difference between the tooth and the ridge is the cutting depth. When sharpening the saw chain (20) you have to consider the following points (Fig. 47).
  - File angle
  - Cutting angle
  - File position
  - Diameter of round file
  - File depth

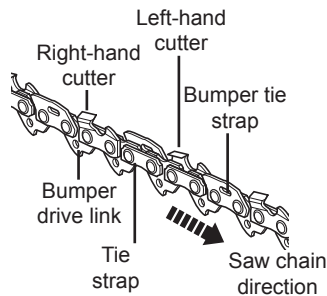

Fig. 47

## Guide bar and saw chain maintenance

3. To sharpen the chain proceed as follows:
  - Use protective gloves.
  - Ensure the chain is correctly tensioned.
  - Engage the chain brake to lock the chain on the bar.
4. Use a chain file, whose diameter is 1.1 times the cutting tooth depth. Make sure 20 % of the file diameter is above the cutter's top plate.



**NOTE:** A file guide is available from most reputable tool merchants and is the easiest way to hold the file at the correct position.

5. File at an angle perpendicular to the bar, and at an angle of  $25^\circ$  to the direction of travel (Fig. 48).

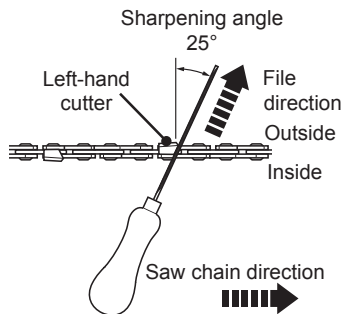

Fig. 48

6. File each tooth from the inside towards outside only. File one side of the chain first than turn the saw around and repeat the process.
7. Sharpen each tooth equally by using the same number of strokes.
8. Keep all cutter lengths equal. Check the safety depth gauge height every 5 sharpenings. If the depth gauges are also trimmed it is essential that the original profile be restored.

9. Use a depth gauge measuring instrument to check the height of the depth gauge. Depth gauge measuring jigs are available from most reputable tool merchants (Fig. 49).

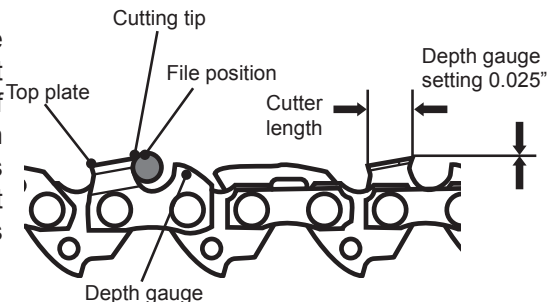

Fig. 49

## Spare parts/Replacement parts

---

Spare parts are available at an authorised dealer or through our customer service.

## Repair

---

This product does not contain any parts that can be repaired by the consumer. Contact an authorised service centre or a similarly qualified person to have it checked and repaired.

## Storage

---

1. Switch the product off and remove the battery pack.
2. Clean the product as described above.
3. Dismantle the pole assembly if necessary.
4. Attach the blade cover (16) onto the hedge trimmer blade (17) if necessary.
5. Attach the guide bar cover (18) to the saw chain (20) if necessary.
6. Store the product and its accessories in a dark, dry, frost-free, well-ventilated place.
7. Always store the product in a place that is inaccessible to children. The ideal storage temperature is between 10 °C and 30 °C.
8. We recommend using the original package for storage or covering the product with a suitable cloth or enclosure to protect it against dust.
9. Empty the oil tank if you are not going to use the product for an extended period of time (more than 3 months) and before storing it for the winter.

## Transportation

---

1. Switch the product off remove the battery pack.
2. Attach the blade cover (16) onto the hedge trimmer blade (17) if necessary.
3. Attach the guide bar cover (18) to the saw chain (20) if necessary.
4. Always carry the product by its soft grip (7a) of the rear pole (7) and rear handle (1).
5. Protect the product from any heavy impact or strong vibrations which may occur during transportation in vehicles.
6. Secure the product to prevent it from slipping or falling over.

## Troubleshooting

Suspected malfunctions are often due to causes that the users can fix themselves. Therefore check the product using this section. In most cases the problem can be solved quickly.



**WARNING!** Only perform the steps described within these instructions! All further inspection, maintenance and repair work must be performed by an authorised service centre or a similarly qualified specialist if you cannot solve the problem yourself!

Problem	Possible cause	Solution
1. Product does not start	1.1. Battery pack is not properly attached 1.2. Battery pack is discharged 1.3. Battery pack is damaged 1.4. Other electrical defect to the product	1.1. Attach properly 1.2. Remove and charge battery pack 1.3. Check by a specialist electrician 1.4. Check by a specialist electrician
2. Product does not reach full power	2.1. Battery pack capacity is too low 2.2. Air vents are blocked	2.1. Charge battery pack 2.2. Clean the air vents
3. Unsatisfactory cutting result	3.1. Hedge trimmer blade is worn / damaged 3.2. Thickness of branches exceeds capacity 3.3. Saw chain not tensioned properly 3.4. Saw chain is dull damaged	3.1. Replace with a new one 3.2. Only cut branches complying with the capacity 3.3. Tension properly 3.4. Sharpen or replace the saw chain
4. Product suddenly stops	4.1. Battery pack is discharged 4.2. Battery pack is too hot 4.3. Hedge trimmer blade or saw chain is blocked	4.1. Remove and charge battery pack 4.2. Remove battery pack and let it cool down 4.3. Remove blockage
5. Excessive vibration or noise	5.1. Hedge trimmer blade or saw chain is dull damaged 5.2. Bolts/nuts are loosen	5.1. Replace with a new one 5.2. Tighten bolts/nuts



## Recycling and disposal



Waste electrical products should not be disposed of with household waste. Please recycle where facilities exist. Check with your Local Authority or local store for recycling advice.

### **For further information visit [www.recycle-more.co.uk](http://www.recycle-more.co.uk).**

The product comes in a package that protects it against damage during shipping.

Keep the package until you are sure that all parts have been delivered and the product is working properly. Recycle the package afterwards.

### **Disposal of an exhausted battery pack**



The battery is Li-Ion type. To preserve natural resources, please recycle or dispose of the battery pack properly. Consult your local waste authority for information regarding available recycling and / or disposal options.

Discharge your battery pack by operating your tool, then remove the battery pack from the tool and cover the battery pack connections with heavy duty adhesive tape to prevent short circuit and energy discharge.

Do not attempt to open or remove any of the components.

## Guarantee

---

We take special care to select high quality materials and use manufacturing techniques that allow us to create products incorporating design and durability. This product has a manufacturer's guarantee of 2 years against manufacturing defects, from the date of purchase (if bought in store) or date of delivery (if bought online), at no additional cost for normal (non-professional or commercial) household use.

To make a claim under this guarantee, you must present your proof of purchase (such as a sales receipt, purchase invoice or other evidence admissible under applicable law), please keep your proof of purchase in a safe place. For this guarantee to apply, the product you purchased must be new, it will not apply to second hand or display products. Unless stated otherwise by applicable law, any replacement product issued under this guarantee will only be guaranteed until expiry of the original period guarantee period.

This guarantee covers product failures and malfunctions provided the product was used for the purpose for which it is intended and subject to installation, cleaning, care and maintenance in accordance with the information contained in these terms and conditions, in the user manual and standard practice, provided that standard practice does not conflict with the user manual.

This guarantee does not cover defects and damage caused by normal wear and tear or damage that could be the result of improper use, faulty installation or assembly, neglect, accident, misuse, or modification of the product. Unless stated otherwise by applicable law, this guarantee will not cover, in any case, ancillary costs (shipping, movement, costs of uninstalling and reinstalling, labour etc), or direct and indirect damage.

Rights under this guarantee are enforceable in the country in which you purchased this product. Guarantee related queries should be addressed to the store you purchased this product from.

The guarantee is in addition to and does not affect your statutory rights.

**Manufacturer:**

Kingfisher International Products Limited  
3 Sheldon Square, W26PX London United Kingdom  
[www.kingfisher.com/products](http://www.kingfisher.com/products)

**Distributor:**

B&Q plc

Chandlers Ford, Hants, SO53 3LE, United Kingdom

[www.diy.com](http://www.diy.com)

Screwfix Direct Limited

Trade House, Mead Avenue, Yeovil, BA22 8RT, United Kingdom

[www.screwfix.com](http://www.screwfix.com)

In more detail...

## Technical specifications

### General

- > Rated voltage : 18 V 
- > Rated no load speed  $n_0$  : 2400 min<sup>-1</sup>
- > Protection class : III
- > Weight : approx. 5.6 kg
- > Telescopic length : 184-234 cm
- > Dimensions : approx. 130\*85\*(2694-3069) mm

### Pole hedge trimmer

- > Blade length : 50 cm
- > Max. cutting length : 45 cm
- > Tooth gap : max. 20 mm

### Pole chain saw

- > Chain type : 91P033X Oregon
- > Guide bar type : 080SDEA041 Oregon
- > Guide bar length : 203 (8")
- > Max. cutting length : 180 mm
- > Chain pitch : 9.525mm (0.375")
- > Chain gauge : 1.27 mm (0.050")
- > Drive sprocket : 6 teeth x 30 mm
- > Maximum chain speed : 4.5 m/s

### Battery pack

- > Model no. : TTI803BAT
- > Type : Li-Ion, 5 x 3.6 V 
- > Capacity : 5000 mAh
- > Voltage : 18 V 
- > Weight : approx. 0.69 kg

### Charger for battery pack

- > Model no. : TTB805CHR
- > Rated output : 21.4 V d.c., 4 A

### Usable battery pack (sold separately)

- > Model no. : TTI802BAT                      TTB812BAT
- > Capacity : 4000 mAh                      8000 mAh

### Usable charger (sold separately)

- > Model no. : TTB804CHR                      TTB815CHR
- > Rated output : 21.4 V d.c., 2.4 A    21 V d.c., 8 A
- > Ambient temperature range for charger and battery use : 5 °C to 40 °C

**Sound values**

> Sound pressure level $L_{pA}$ as hedge trimmer	: 74 dB(A)
> Sound pressure level $L_{pA}$ as pruner	: 76 dB(A)
> Uncertainty $K_{pA}$ as hedge trimmer	: 3 dB(A)
> Uncertainty $K_{pA}$ as pruner	: 2.5 dB(A)
> Measured sound power level $L_{WA}$ as hedge trimmer	: 85.3 dB(A)
> Measured sound power level $L_{WA}$ as pruner	: 93.8 dB(A)
> Uncertainty $K_{WA}$ as hedge trimmer	: 1.5 dB(A)
> Uncertainty $K_{WA}$ as pruner	: 1.7 dB(A)
<b>Hand arm vibration values</b>	
> $a_h$ as hedge trimmer	: 1.0 m/s <sup>2</sup>
> $a_h$ as pruner	: 1.2 m/s <sup>2</sup>
> Uncertainty $K$	: 1.5 m/s <sup>2</sup>

The sound values have been determined according to noise test code given in EN 62841-4-2, EN ISO 11680-1 using the basic standards EN ISO 11201 and EN ISO 3744.

The sound intensity level for the operator may exceed 80 dB(A) and ear protection measures are necessary.

The declared vibration value has been measured in accordance with a standard test method (according to EN 62841-4-2, EN ISO 11680-1). The declared vibration total value and the declared noise emission value may be used for comparing one tool with another. The declared vibration total value and the declared noise emission value may also be used in a preliminary assessment of exposure.



**WARNING!** Depending on the actual use of the product the vibration and noise values can differ from the declared total. Adopt proper measures to protect yourself against vibration exposures. Take the whole work process including times the product is running under no load or switched off into consideration.

Proper measures include among others regular maintenance and care of the product and accessories, keeping hands warm, periodical breaks and proper planning of work processes.

## Rating label explanation

---

### **Hedge trimmer/ Pruner: TTT831HDC-Li = MODEL NUMBER**

TTB= TITAN (brand)

831= Series number

HDC= Hedge trimmer/ Pruner

### **Battery pack: TTI803BAT = MODEL NUMBER**

TTB= TITAN (brand)

803 = Series number

BAT = Battery pack

### **Charger: TTB805CHR = MODEL NUMBER**

TTB= TITAN (brand)

805 = Series number

CHR = Charger

# Declaration of conformity

---

In more detail...

# TITAN

---

**Manufacturer, Fabricant, Producent, Producător, Fabricante:**

**UK Manufacturer:**

Kingfisher International Products Limited  
3 Sheldon Square, London, W2 6PX  
United Kingdom  
[www.kingfisher.com/products](http://www.kingfisher.com/products)

**EU Manufacturer:**

Kingfisher International Products B.V.  
Rapenburgerstraat 175E  
1011 VM Amsterdam  
The Netherlands  
[www.kingfisher.com/products](http://www.kingfisher.com/products)

- |           |  |   |
|-----------|--|---|
| <b>EN</b> | <a href="http://www.diy.com">www.diy.com</a><br><a href="http://www.screwfix.com">www.screwfix.com</a><br><a href="http://www.screwfix.ie">www.screwfix.ie</a> | To view instruction manuals online, visit<br><a href="http://www.kingfisher.com/products">www.kingfisher.com/products</a>                                   |
| <b>FR</b> | <a href="http://www.castorama.fr">www.castorama.fr</a><br><a href="http://www.bricodepot.fr">www.bricodepot.fr</a>   | Pour consulter les manuels d'instructions en ligne,<br>rendez-vous sur le site <a href="http://www.kingfisher.com/products">www.kingfisher.com/products</a> |
| <b>PL</b> | <a href="http://www.castorama.pl">www.castorama.pl</a>   | Aby zapoznać się z instrukcją obsługi online, odwiedź<br>stronę <a href="http://www.kingfisher.com/products">www.kingfisher.com/products</a>                |
| <b>ES</b> | <a href="http://www.bricodepot.es">www.bricodepot.es</a>   | Para consultar los manuales de instrucciones en línea,<br>visite <a href="http://www.kingfisher.com/products">www.kingfisher.com/products</a>               |
| <b>PT</b> | <a href="http://www.bricodepot.pt">www.bricodepot.pt</a>   | Para consultar manuais de instruções online, visite<br><a href="http://www.kingfisher.com/products">www.kingfisher.com/products</a>                         |
| <b>RO</b> | <a href="http://www.bricodepot.ro">www.bricodepot.ro</a>   | Pentru a consulta manualele de instrucțiuni online, vizitați<br><a href="http://www.kingfisher.com/products">www.kingfisher.com/products</a>                |
| <b>TR</b> | <a href="http://www.koctas.com.tr">www.koctas.com.tr</a>   | Kullanım kılavuzuna internet üzerinden ulaşmak için<br><a href="http://www.kingfisher.com/products">www.kingfisher.com/products</a> adresini ziyaret edin   |